

STORM MEDIUM LONG 25 cc



STORM SYSTEM®

The Storm Medium Long 25 is part of the STORM SYSTEM® MEDIUM collection. A collection that includes a wide range of special designed products. The STORM SYSTEM® collection is carefully designed to flush the surface of any ceiling or wall, and all products will appear with an absolute minimum of tolerance and visibility.

Storm Medium Long 25 is designed to rotate 360° and allows a 25° adjustment along the longitudinal axis, and is available in different colour combinations.

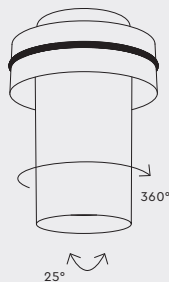
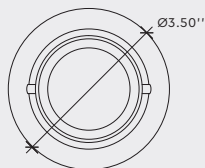
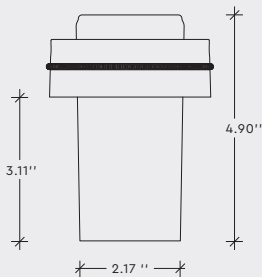

The crossed-out wheeled bin symbol indicates that the item should be disposed of separately from household waste. The item should be handed in for recycling in accordance with local environmental regulations for waste disposal

For more information, please contact info@onea.dk

DATA

Collection	STORM SYSTEM®
Product	Storm Medium Long 25 – Constant Current
Article no.	1N01.0142.xx04

SPECIFICATIONS

Weight	15.9 oz
Material	Aluminium
IP protection grade	IP20
Labelling	



Conforms to ANSI/UL
Std. UL 2108:2015

Cert. to CAN/CSA
Std. CSA C22.2#250.13:2017

Intertek
5005519

Safety distance	0,3m
Supply	Constant Current max. rating: 15W
Insulation class	Class III
Fixture finish	For xx-codes review STORM SYSTEM® – COLOUR CODES ➤

ADDITIONAL REQUIREMENTS

Light Source & Junction Kit	MR16 LED (light source not included) review STORM SYSTEM® – CONFIGURATION ➤
	For IES/LDT lux files review STORM SYSTEM® – LUX FILES ➤
	NOTE: when using honey combs the lumen output will be reduced with 30% in efficiency

This product shall always be powered by SELV LED driver, output voltage of this driver in open circuit must not exceed 60V. Do NOT cover the LED driver or locate LED driver on top of light fixture.

For further support contact LITES ON WEST
245 West 29th Street, 6th floor | NY, NY 10001
T: 212 775 6363 | F: 212 775 0355
E: info@litesonwest.com

INSTALLATION DEPTH

The installation depth may vary depending on the chosen light source.

For specific light source conditions
– review STORM SYSTEM® – INSTALLATION DEPTH ➤

IMPORTANT INFORMATION

Installation and mounting must be performed by a certified electrician only, and instructions must be followed.

Always make sure the main power is off during installation. Pay attention to the fixture remarks, and always make sure to use the correct voltage.

CLEANING AND MAINTENANCE:

Use a soft moist cloth for cleaning. No further maintenance is required.

WARRANTY:

If the product is defect, please contact your supplier immediately. Please note that warranty will not apply in case of wrongful use or if unskilled personnel attempts to repair.

COMPONENTS

- Storm Medium Long 25
- Spring
- Honeycomb

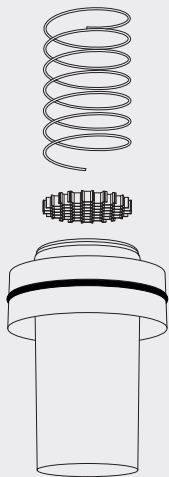

PLEASE NOTE:

If the spring on the fixture is damaged, do not proceed installation – contact your dealer

STORM MEDIUM LONG 25

ASSEMBLY INSTRUCTION

STEP 1

Make sure main power is off!

Pull back the spring

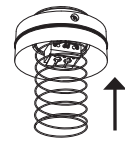

STEP 2

Mount your chosen light source or socket, guide the wire/socket through the hole in the base of the fixture



STEP 3

Mount the Storm Long tube, by gently rotating the tube into place.

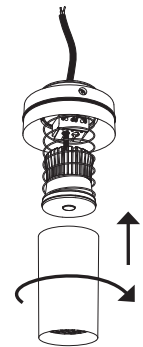

STEP 4

Mount the chosen Junction Kit

Then mount the fixture into the plaster ring/back-mounted ring. Do this by slightly rotating the fixture.

NOTE: When rotating the fixture choose the direction with the least resistance.

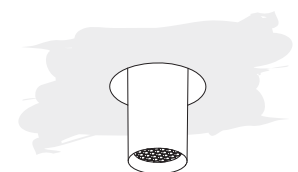
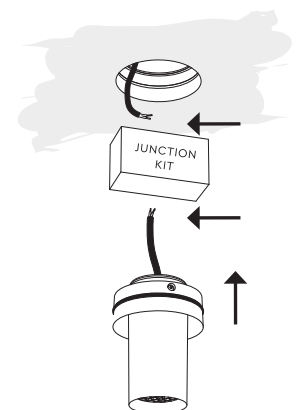

IMPORTANT INFORMATION

Disassembly must be performed by a certified electrician only, and instructions must be followed. Always make sure the main power is off during installation. Pay attention to the fixture remarks, and always make sure to use the correct voltage.

WARRANTY:

If the product is defect, please contact your supplier immediately. Please note that warranty will not apply in case of wrongful use or if unskilled personnel attempts to repair.

STORM MEDIUM LONG 25

DISASSEMBLY INSTRUCTION

STEP 1

Make sure main power is off!
Take hold of the fixture and pull down gently, whilst slightly rotating.

NOTE: When rotating the fixture choose the direction with the least resistance.

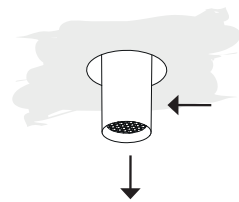

STEP 2

Disconnect the cables

